

Magnetic Reed Switch

LS-311-B31



Manufacturer

Shenzhen Longsin Intelligence Technology CO.,Ltd

Address: Block B, Kaijieda Industrial Zone, Huachang Road, Dalang, Longhua Town, Baoan District, Shenzhen, China

Website: www.longsin.cn

Magnetic Reed Switch

Description

The Magnetic Reed Switch LS-311-B31 is with permanent magnet and can be used for door and windows. It is easy to be mounted on the surface. When the detector is working, the permanent magnet make the contacts of the reed switch connectivity, and output switch signals for the alarm system (passage alarm, open circuit alarm). The detector should be used according to the material of the door/window, installation method and movement distance.

Technical Specifications

Product Category	LS-311-B31
Max working voltage	100Vdc
Max working current	0.5ACurrent
Power	0.5A
Sensor distance	15-25mm
The initial switch's resistance	≤200mΩ (The resistance will increase as the wiring get longer)
Switch type	N.C
Alarm output type	Signal output (NC--When the magnet need the switch, reed switch is closed, the signal line is connect. If the door is opened, the magnet left switch, reed contact is disconnected, the signal line is interrupt, known as "circuit alarm". NO--NC & NO--Conversion output optional)
Color	White/brown
Material	ABS
Mounting	Surface
Size	64*12.8*12.8mm

Diagram

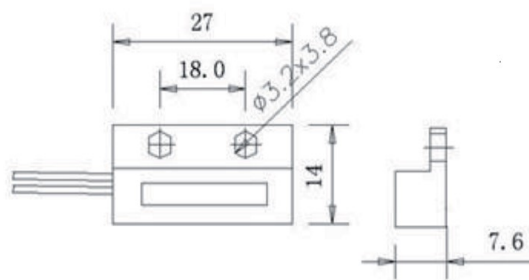

Tolerance: ± 0.5mm